



MOVE INN ESTATES
MAKING THE RIGHT MOVE



Staines Road



Floor Plan

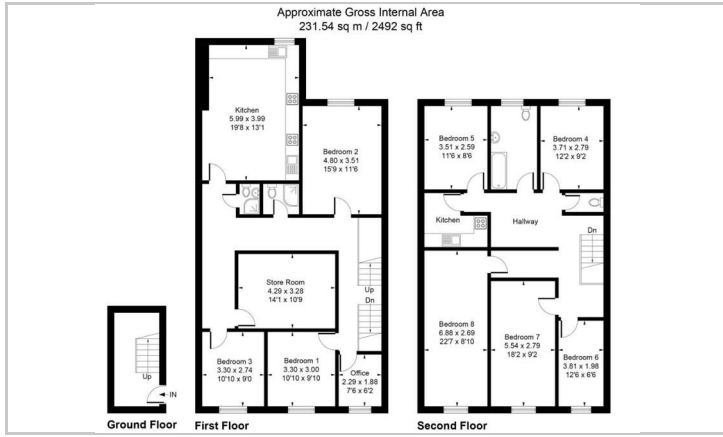

Area Map

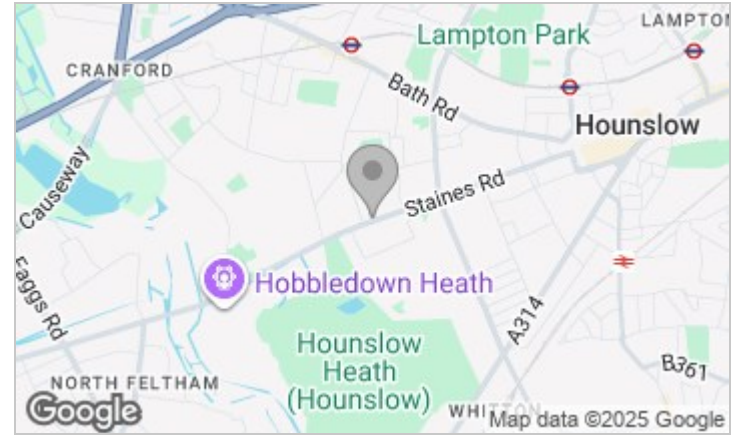

****Spacious 10-Bedroom HMO on Staines Road, Hounslow – Available End of October 2025 – £5,700 PCM****

We are delighted to offer this fully licensed and fully furnished 10-bedroom HMO property located on the sought-after Staines Road in Hounslow. Ideal for professional tenants or companies looking for compliant and comfortable accommodation.

- Available from End of October 2025
- Licensed for 8 households / 11 occupants
- £5,700 PCM (excluding bills)
- Fully Furnished
- 2 Modern Communal Kitchens
- Multiple Bathrooms for Convenience
- Excellent Transport Links & Local Amenities Nearby

This large property boasts a generous layout with 10 well-sized bedrooms, multiple shared bathrooms, and two fully-equipped communal kitchens, providing both space and functionality for all tenants.

Whether you're a housing provider, employer, or group of sharers, this property offers an ideal solution for high-quality shared living in a well-connected location.

Located close to Hounslow's town centre, with easy access to Heathrow Airport, public transport, and major road links including the A4 and M4.

Contact us today to arrange a viewing or register your interest – this property won't be available for long!



Energy Efficiency Graph

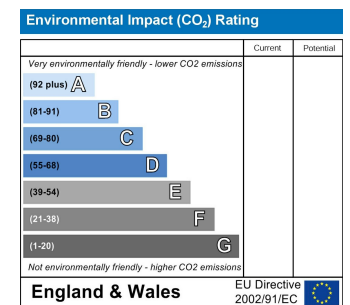
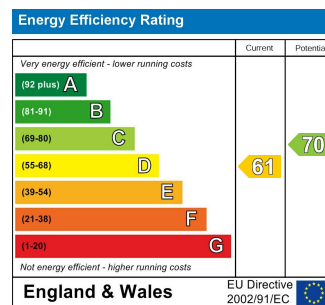

These particulars, whilst believed to be accurate are set out as a general outline only for guidance and do not constitute any part of an offer or contract. Intending purchasers should not rely on them as statements of representation of fact, but must satisfy themselves by inspection or otherwise as to their accuracy. No person in this firm's employment has the authority to make or give any representation or warranty in respect of the property.